

DATED: April 19, 1999 (S/M)

## VENDOR SERVICE PUBLICATION

**TO:** All Piper Domestic and International Distributors, Authorized Piper Service Centers and publication subscribers.

**SUBJECT:** Distribution of: **TEXTRON LYCOMING SERVICE INSTRUCTION NO. 1267C, "PISTON PIN PLUG USAGE".**

**MODELS AFFECTED:**

All Textron Lycoming Piston Engines  
with 5 1/8 inch Cylinder Bores

**SERIAL NUMBERS AFFECTED:**

All Textron Lycoming Piston Engines  
with 5 1/8 inch Cylinder Bores

*Note:*

*A guide to the "Model and Serial Number Affected" is listed on the next page. This should be used as a guide to determine applicability, however, if your serial number or model is not listed here, and you have an engine with 5 1/8 inch cylinder bore, consult with Textron Lycoming using the model and serial number of the engine.*

**COMPLIANCE TIME:** In accordance with the attached TEXTRON LYCOMING Service Instruction SI 1267C, "Piston Pin Plug Usage". *Check the attached publication for compliance time.*

**PURPOSE:** To provide distribution of TEXTRON LYCOMING Service Instruction SI 1267C , "Piston Pin Plug Usage".

## Effectivity Reference Guide

**MODELS AFFECTED:**

PA-18/18-150 Super Cub

PA-18-150 Super Cub  
 PA-20 Pacer  
 PA-22-125/135 TriPacer  
 PA-22-108 Colt  
 PA-23 Apache  
 PA-23 235 Aztec  
 PA-23-250 Aztec

PA-24-180/250 Comanche  
 PA-24-260 Comanche  
 PA-24-400 Comanche  
 PA-28-140 Cherokee  
 PA-28-150/160/180 Cherokee  
 PA-28-151 Warrior  
 PA-28-161 Warrior II

PA-28-161 Warrior III

PA-28-161 Cadet  
 PA-28-181 Archer II

PA-28-181 Archer III

PA-28-235 Cherokee  
 PA-28-236 Dakota

PA-28R-180 Arrow  
 PA-28R-200 Arrow/Arrow II  
 PA-28R-201 Arrow III  
 PA-28R-201 Arrow

PA-28RT-201 Arrow IV  
 PA-30-Twin Comanche  
 PA-31/300/325 Navajo/Navajo CR

PA-31-350 Chieftain

PA-31-350 T1020  
 PA-32-260 Cherokee Six  
 PA-32-300 Cherokee Six  
 PA-32-301 Saratoga

PA-32RT-300T Turbo Lance II  
 PA-32R-300 Lance  
 PA-32RT-300 Lance II  
 PA-32R-301 Saratoga SP

PA-32R-301 Saratoga II HP

PA-32R-301T Turbo Saratoga SP

PA-32R-301T Saratoga II TC  
 PA-34-200 Seneca  
 PA-38-112 Tomahawk  
 PA-39-Twin Comanche  
 PA-44-180 Seminole

PA-44-180T Seminole  
 PA-46-350P Malibu Mirage

**SERIAL NUMBERS AFFECTED:**

18-1 through 18-9004  
 18- 7309016 through 18-8309025  
 1809001 through 1809113  
 20-1 through 20-1121  
 22-1 through 22-2424  
 22-8000 through 22-9848  
 23-1 through 23-2046  
 27-505 through 27-622  
 27-1 through 27-4866  
 27-7304917 through 27-8154030  
 24-1 through 24-3687  
 24-3642, 24-4000 through 24-5028  
 26-2 through 26-148  
 28-20000 through 28-7725290  
 28-1 through 28-7505259 & 28-E13  
 28-7415001 through 28-7715314  
 28-7716002 through 28-8616057  
 2816001 through 2816109  
 2816110 through 2816119,  
 2842001 and up  
 2841001 through 2841365  
 28-7690001 through 28-8690056  
 2890001 through 2890205  
 2890206 through 2890231  
 2843001 and up  
 28-10001 through 28-7710089 & 28-E11  
 28-7911001 through 28-8611008  
 2811001 through 2811050  
 28R-30001 through 28R-7130013  
 28R-35001 through 28R-7635545  
 28R-7737001 through 28R-7837319  
 2837001 through 2837061  
 2844001 and up  
 28R-7918001 through 28R-8218026  
 30-1 through 30-2000  
 31-2 through 31-861  
 31-7300901 through 31-8312019  
 31-5001 through 31-5004  
 31-7305005 through 31-8452021  
 31-8253001 through 31-8553002  
 32-1 through 32-7800008  
 32-40000 through 32-7940290  
 32-8006001 through 32-8606023  
 3206001 through 3206088  
 32R-7787001 through 32R-7987126  
 32R-7680001 through 32R-7880068  
 32R-7885001 through 32R-7985105  
 32R-8013001 through 32R-8613006  
 3213001 through 3213041  
 3213029, 3213042 through 3213103  
 3246001 and up  
 32R-8029001 through 32R-8629006  
 3229001 through 3229003  
 3257001 and up  
 34-7250001 through 34-7450220  
 38-78A0002 through 38-82A0124  
 39-1 through 39-155  
 44-7995001 through 44-8195026, 4495001  
 through 4495013, 4496001 through 4496020,  
 44-8107001 through 44-8207020  
 4622001 through 4622200, 4636001 and up

# SERVICE INSTRUCTION

DATE:

February 26, 1999

Service Instruction No. 1267C  
(Supersedes Service Instruction No. 1267B)  
Engineering Aspects are  
FAA Approved

SUBJECT:

Piston Pin Plug Usage

MODELS AFFECTED:

All Textron Lycoming engines with 5-1/8 inch cylinder bore: O-320; IO-320; O-340, O, IO, HO, LO, LIO, AIO, HIO, TIO, VO and IVO-360; GO, VO and TVO-435; GO, GSO, IGSO-480; O, IO, VO, TIO, TVO, TIVO and IGSO-540; TIO and TIGO-541; IO-720.

TIME OF COMPLIANCE:

Any time piston pin plugs are replaced.

There are three different piston pin plugs currently used in the above mentioned models of Textron Lycoming aircraft engines. The various plugs fit interchangeably; however, both plugs in a cylinder must be of the same part number. To preclude the possibility of mixing two different plugs in a cylinder and to simplify plug replacement, at the next piston pin plug replacement, plug P/N LW-11775 should be replaced with P/N 72198. In a complete engine piston pin plug replacement, all plugs should be replaced with P/N 72198. See the illustrations for allowable replacements.

## NOTE

Although piston pin P/N LW-14077\* was designed to accommodate the P/N LW-11775 plug, P/N 60828 and P/N 72198 plugs may be used with P/N LW-14077 pins. Follow the replacement applications listed below.

Piston pin plug replacement is mandatory during engine overhaul and care should be exercised to be sure the clearance between the plug and piston is not excessive; normal fit is .0002L/.0015L, service maximum .0025L.

## CAUTION

Both pin plugs in a cylinder must be of the same part numbers and must be replaced in accordance with the illustrated applications. Coat thrust face of plugs with Texaco Tuban 140 or other pre-lubricant before assembly. See latest edition of Service Instruction No. 1059 for approved lubricants.

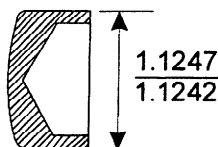
P/N 60828 ALUMINUM  
PISTON PIN PLUG

In individual cylinders, replace both with P/N 60828 Piston Pin Plugs. In complete engine, replace all with P/N 72198.

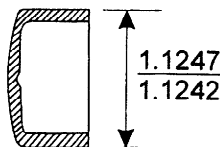
P/N 72198 ALUMINUM BRONZE  
PISTON PIN PLUG

Replace both plugs in cylinder with P/N 72198 Piston Pin Plug.

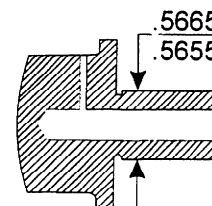
P/N LW-11775 ALUMINUM  
PISTON PIN PLUG

Remove from service. Replace both pin plugs in cylinder with Piston Pin Plug P/N 72198.

Chart Showing Section Thru Piston Pin Plugs

NOTE

For O-320-E2A, when piston pin P/N LW-14077 is installed, a logbook entry is required.

\* – Piston pins P/N's 69650, LW-12383, LW-13444 and LW-13446 are all superseded by piston pins P/N LW-14077 and LW-14078; see latest edition of Service Instruction No. 1340 for parts information.

NOTE: Revision "C" removes P/N LW-11775 piston pin plug from service.